

Product Model	A	B	C	E	F	G	K	Max Weight kg.
								3Ph
SLCS400/4-3	400	475	400	8	12	450	20	35
SLCS400/2-3A	400	470	400	8	12	450	20	37
SLCS400/2-3B	400	475	400	8	12	450	20	42
SLCS500/4-3A	500	585	400	12	12	560	20	41
SLCS500/4-3B	500	585	400	12	12	560	20	45
SLCS500/2-3A	500	585	400	12	12	560	20	47
SLCS500/2-3B	500	585	450	12	12	560	25	68
SLCS560/4-3A	560	645	400	12	12	620	20	43
SLCS560/4-3B	560	645	400	12	12	620	20	49
SLCS630/4-3A	630	715	400	12	12	690	20	52
SLCS630/4-3B	630	715	450	12	12	690	20	64
SLCS710/4-3A	710	795	450	16	12	770	20	67
SLCS710/4-3B	710	795	470	16	12	770	25	111

## ACCESSORIES

- ◆ Mounting Feet
  - ◆ Anti-Vibration Mounts
  - ◆ Matching Flanges
  - ◆ Flexible Connectors
  - ◆ Silencers
  - ◆ Bell Mouth Inlet\*
  - ◆ Non-Return Dampers\*
  - ◆ Wire Guards (recommended)
- \* can be supplied to order

## SPECIFICATION

### General

The Smokevent long cased axial fan range SLCS shall be from the Select range of Elta Fans Ltd. The all metal fan casing shall provide a long lasting robust construction. All parts shall be heavy gauge mild steel sheet roll formed and welded, then hot dipped galvanised to BS729 after fabrication.

### Impeller Assemblies

Adjustable pitch aerofoil impellers shall be provided with blades made from high quality pressure die cast aluminium (LM6), natural finish. These shall be factory set at an angle to provide maximum performance. Hubs shall be made from die cast aluminium alloy (LM24). Assembled impellers will have their blades positively locked by pinning, for added security, for operation in the smoke regime. Assembled impellers are to be dynamically balanced to Grade 6.3.

### Motors

Motors are to be pad mounted totally enclosed metric frame to IP55 standard. They are suitable for use at normal continuous duty and a once only use under smoke operation at 300°C for 2 hours. The motors are of cast iron construction with windings with Class H insulation. Flying leads are brought out via a temperature resistant conduit system, to an external terminal block for customer cabling interface.

### Quality Management / Certification

Units are to be designed and manufactured with procedures as defined in BS EN ISO 9001:2000. EEC directives shall be met.

Units are tested at elevated temperatures to the requirements of BS 7346 pt 2:1990.

All SLCS units are to be tested to ISO 5801:1997 (airside performance) and BS 848 pt 2:1985 (sound performance).

**NOTE:** The fan units included in this range are part of a more extensive series covering sizes 315mm to 1400mm, that can be manufactured. These units have been tested to the requirements of BS 7346:1990 for smoke applications.

Product testing to the European Standard EN 12101-03:2002 requirement is underway, and will become progressively available.

## THREE PHASE - FIXED SPEED 380V-415V / 3PH / 50HZ

Product Code	Speed rpm	Airflow m <sup>3</sup> /sec @ Static Pressure Pa.												Motor Electrical Data			A.V. Mounts	Sound Level dBA @ 3m	Silencer Data						Availability			
		0	50	100	150	200	250	300	400	500	600	700	800	1000	FL Amps	SC Amps			Output kW	dBA Attenuation		ΔP (Pa)		dBA Attenuation		ΔP (Pa)		
		1DENP	1DEP	1DEP	2DENP	2DEP	2DEP				1DENP	1DEP	1DEP	2DENP	2DEP	2DEP												
SLCS400/4-3	1410	1.38	1.28	1.15	0.93										1.53	8.00	0.55	ES20/20B	53	-9	-12	21	-14	-15	32	●		
SLCS400/2-3A	2845	1.55	1.51	1.48	1.45	1.41	1.37	1.32	1.21	1.08	0.91	0.67	0.38		2.30	15.0	1.1	ES20/20B	72	-10	-14	22	-17	-21	34	●		
SLCS400/2-3B	2780	2.45	2.41	2.37	2.32	2.27	2.22	2.17	2.04	1.89	1.69				4.40	29.0	2.2	ES20/20B	67	-9	-12	66	-14	-15	101	●		
SLCS500/4-3A	1410	2.16	2.03	1.88	1.69	1.41									1.53	8.00	0.55	ES20/20B	60	-10	-13	20	-15	-15	31	●		
SLCS500/4-3B	1400	2.85	2.68	2.49	2.25	1.90									2.76	15.0	1.1	ES20/20B	60	-9	-12	34	-14	-15	51	●		
SLCS500/2-3A	2845	2.60	2.56	2.51	2.46	2.41	2.35	2.30	2.18	2.04	1.89	1.72	1.52	0.96	4.40	29.0	2.2	ES20/40B	80	-10	-16	25	-16	-24	39	●		
SLCS500/2-3B	2865	4.11	4.05	3.99	3.93	3.86	3.80	3.72	3.57	3.40	3.21	2.99	2.71		7.57	58.0	4.0	ES20/40B	79	-9	-16	74	-16	-23	114	●		
SLCS560/4-3A	1410	2.29	2.15	1.99	1.80	1.55	1.18								1.53	8.00	0.55	ES20/40B	64	-10	-13	11	-17	-20	16	●		
SLCS560/4-3B	1405	3.95	3.77	3.56	3.31	2.97									3.48	20.0	1.5	ES20/40B	62	-9	-12	44	-14	-15	66	●		
SLCS630/4-3A	1400	3.10	2.97	2.82	2.66	2.46	2.22	1.91							2.76	15.0	1.1	ES20/40B	67	-10	-16	17	-15	-24	26	●		
SLCS630/4-3B	1425	4.78	4.62	4.43	4.23	3.99	3.71	3.34							4.83	32.0	2.2	ES20/40B	66	-10	-14	41	-14	-21	62	●		
SLCS710/4-3A	1425	5.08	4.92	4.74	4.54	4.32	4.06	3.74							4.83	32.0	2.2	ES20/40B	73	-10	-17	30	-15	-26	46	●		
SLCS710/4-3B	1445	8.40	8.14	7.86	7.56	7.24	6.88	6.47							11.4	75.0	5.5	ES20/70B	75	-10	-14	77	-14	-21	113	●		

The use of Inverters with these fan units during normal ventilation mode must be approved by Elta Fans Ltd.

Sound levels are average spherical free field values (for comparative use only). Value at 50% peak pressure.

Inverter control use during Smoke extract mode is not permitted.

All starting currents are quoted as direct-on-line.

**Availability:**  
 ● Standard - 10 working days

## MOUNTING FEET

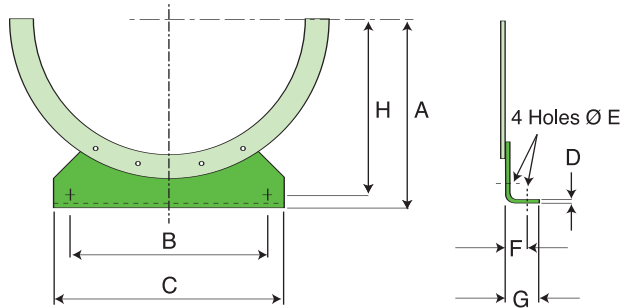

Fan Dia.	A	B	C	D	E	F	G	H	Wt. kg.
400	250	350	400	4	9	27.5	50	230	1.5
500	315	450	500	4	11	27.5	50	290	2.5
560	355	510	560	5	11	32	60	330	4.0
630	400	580	630	5	11	32	60	375	5.0
710	450	660	710	5	11	32	60	425	5.5

For free standing support. Mounts directly to casing flange. Supplied individually, less fixings.

### Material & finish

Steel, hot dipped galvanised.

**Note:** For product codes please refer to price list

## ANTI-VIBRATION MOUNTS

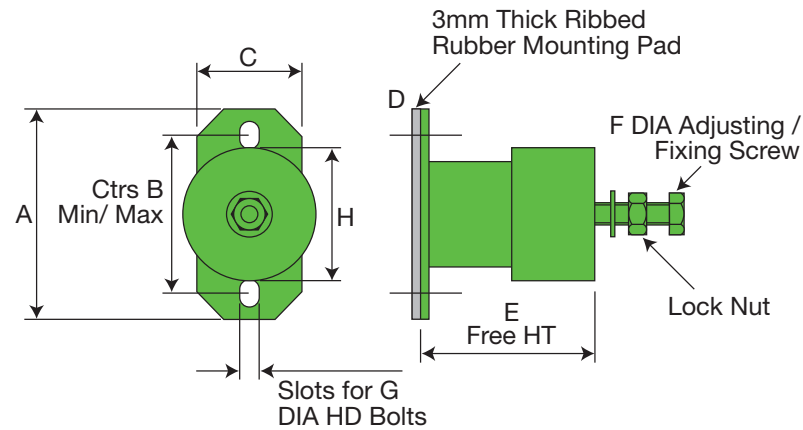

Spring AV Mount Dimensions									
Type	A	B Centres Min/Max	C	D	E	F	G	H	Wt. kg.
ES20 / 20B	76	54/60	38	6	63	M8	M6	48	0.25
ES20 / 40B									
ES20 / 70B									

Fits directly to mounting feet to help minimise noise and vibration. Supplied in sets of 4, complete with fixings to mounting feet.

### Material & finish

Spring AV Mounts - zinc plated steel, rubber insert and foot pad.

## MATCHING FLANGES

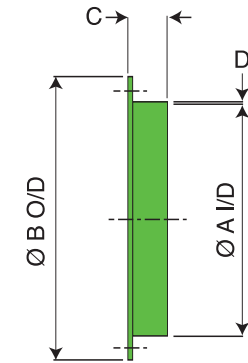

Fan Dia. A	B	C	D	Weight kg.
400	475	40	1.5	1.1
500	585	45	2.0	2.6
560	645	45	2.0	3.0
630	715	45	2.0	3.4
710	795	45	2.0	3.7

Fits directly to fan casing mounting flange to provide a coupling for a Flexible Collar, or an alternative fixing for any other matched interconnection. Supplied individually less fixings.

### Material & finish

Steel, hot dipped galvanised.

## FLEXIBLE COLLAR & CLIPS

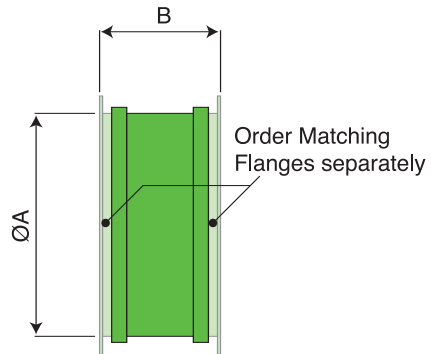

Fan Dia. A	B	Wt. kg.
400	150	2.5
500	150	5.0
560	150	5.5
630	200	6.0
710	200	6.5

Fits directly between matching flanges so as to provide a flexible interconnection with any matched interface e.g. ducting. Supplied individually, complete with fixing bands.

### Material & finish

Silicone coated, fully cured, flame retardant, glassfibre material, plated steel banding

- **Alternative materials available to order**

## SILENCERS

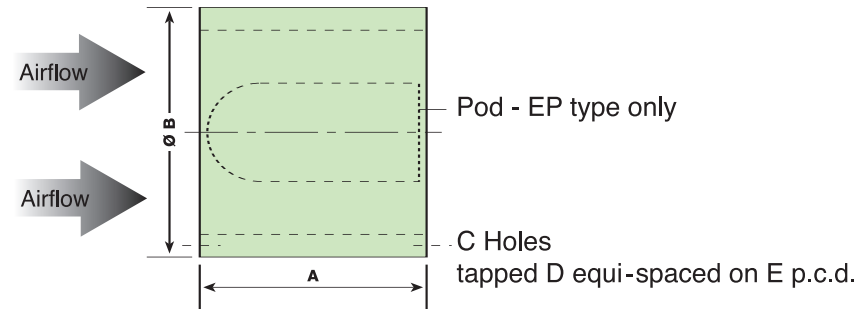

Fan Dia.	A 1D	A 2D	B	C	D	E	Weight kg.			
							1DENP	1DEP	2DENP	2DEP
400	400	800	500	8	M10	450	13	16	22	26
500	500	1000	653	12	M10	560	18	22	32	37
560	560	1120	713	12	M10	620	22	26	39	46
630	630	1260	785	12	M10	690	26	32	48	57
710	710	1420	865	16	M10	770	32	39	59	71

Four variants of attenuators are available. 1DENP & 2DENP are a straight through design whilst 1DEP & 2DEP contain a cylindrical centrebody for enhanced attenuation. This latter type incurs an airside pressure drop. Silencers are supplied less fixings.

### Material & finish

Pre-galvanised steel sheet casing and perforated lining. High density mineral wool in-fill with glass tissue facing. These silencers are not suited to saturated conditions - Refer to Elta.