



SJ IN-LINE CENTRIFUGAL RANGE

The ELTA SJ range of "In-line centrifugal" fans is designed for installations where increased pressure development to overcome resistance is needed.

There are seven sizes with up to eleven variations, depending on model size and specific characteristics.



Technical Specification

- One-year guarantee.
- Duty range 50 l/sec (180m³/h) to 510 l/sec (1836m³/h) at pressures up to 700 Pa.
- High Efficiency single inlet, single width backward curved centrifugal impeller, designed to be non overloading and self cleaning.
- Heavy gauge steel housing with epoxy finish, scratch proof and weather resistance.
- High efficiency, maintenance free external rotor motors with inbuilt **Thermal Overload** protection, matching the aerodynamic performance of the impeller.
- Motors are weather proofed to IP44 and suitable for speed control.
- Maximum ambient working temperature is 60°C.
- Connections via an IP54 rated terminal box which is fitted onto the unit casing.
- All fans are **CE** marked and comply with relevant EEC directives.
- All fans tested to ISO 5801:1997 (airside performance) and BS 848 Pt 2: 1985 (sound performance).

Dimensions

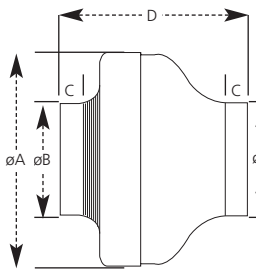

Model	øA	øB	C	D
SJ100A	241	98	25	210
SJ100B	241	98	25	210
SJ125A	241	123	25	210
SJ125B	241	123	25	210
SJ150	241	148	25	210
SJ160	241	158	25	210
SJ200A	335	198	25	230
SJ200B	335	198	25	230
SJ250	335	248	25	230
SJ315A	404	313	30	295
SJ315B	404	313	30	308

Optional Features.

Speed controllers
149-EL21. 149-EL31.



Electric heaters
018-0100 to 0315-HEAT-1.



Panel filters
018-0100 to 0315-FILT-P.



Back draught dampers
018-100 to 315-DAMPER.



Fast clamps
018-100 to 315-CLAMP.



Silencers
068-0100 to 0315-JF1/JF2/JF3/JF4.



Performance Data

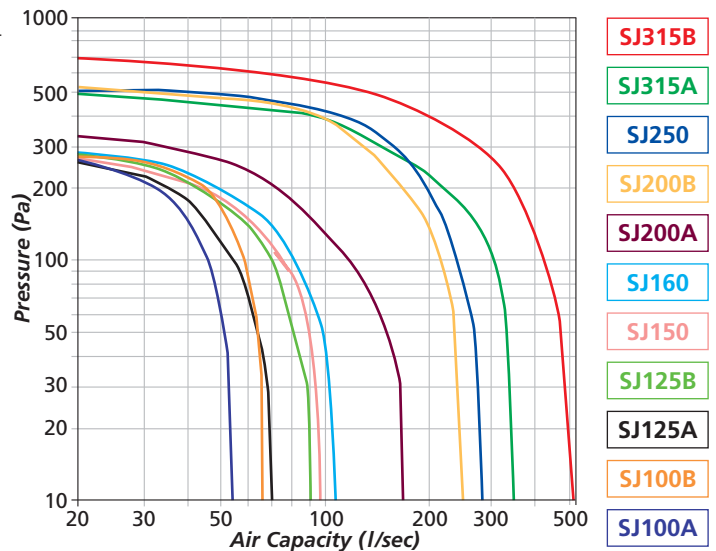

Technical Information

Model	Diameter	Volts	Watts	R.P.M	l/sec	MaxPa	dB@3m
SJ100A	98	230	68	2000	50	300	34
SJ100B	98	230	60	2400	60	300	42
SJ125A	123	230	62	1700	70	300	36
SJ125B	123	230	58	2350	90	300	43
SJ150	148	230	65	2350	100	250	46
SJ160	158	230	63	2350	110	250	49
SJ200A	198	230	73	2400	170	250	51
SJ200B	198	230	154	2430	240	500	52
SJ250	248	230	180	2450	280	500	53
SJ315A	313	230	192	2420	350	500	52
SJ315B	313	230	297	2630	510	700	56